

# HMAS Adelaide Monument

*Approximate  
site location*

*Approx. HMAS  
ADELAIDE location*



Project Locality



## GENERAL

Works are to be carried out in accordance with the following list of standards. This list may not be exhaustive.

REFERENCE	TITLE
AS 1170 (Part1)	Structural design actions— Preferment, imposed and other action
AS 1170 (Part2)	Structural design actions—Wind actions
AS 1319	Safety signs for the occupational environment
AS/NZS 1576 (set)	Scaffolding- General requirement
AS I657	fixed platform, walkways, stairways and ladders- design, construction & installation
AS 1674.1	Safety in welding and allied processes- Fire precautions
AS/NZS 1680.1	Interior and workplace lighting— General principles and recommendations
AS/NZS 1650.2.4	Interior lighting—industrial tasks and processing
AS 1668.2	The use of ventilation and air conditioning in buildings
AS 1926	Swimming Pool Safety
AS 1940	The storage and handling of flammable and combustible liquids
AS 2550 (set)	Cranes, hoists and winches- Safe use- General requirements
AS 2601	The demolition of structures
AS 3000	Electrical installation (known as the Australian New Zealand wiring roles)
AS 2890 (set)	Parking Facilities Set
AS 3610	Formwork for concrete
AS 3610 (Sup 2)	Formwork for concrete- Commentary
AS 3600	Concrete structures
AS 3828	Guidelines for the erecting of building steelwork
AS 3850.1	Pre- fabricated concrete elements- General Requirements
AS 3550.2	Pre- fabricated concrete elements—Building Construction
AS 3959	Construction of buildings in bushfire prone areas
AS 4024.1 (set)	Safety of machinery
AS 4100	Steel structures
AS/AZS 4114	Sprat pointing booths
AS/NZS 4360	Risk management
AS/NZS 4359	Safety mesh
AS/NZS 4576	Guidelines for scaffolding

AS/NZS 4801 OH&S management systems- Specification with guidance for use  
AS/NZS 4994. Roof edge protection equipment.

All works are to comply with the NCC (National Construction Code) and all relevant authority requirements including (but not limited to) the following requirements:

## CONTRACTORS AND SUBCONTRACTORS

All contractors and subcontractors have environmental responsibilities during the performance of their various activities on the Project in particular:

- The submission to the Project Manager of their own documentation which complies with Federal, State, and Local Authority regulations and the contents of this CEMP,

- The preparation and implementation of specific environmental control plans deemed necessary by the Project Manager or his nominee to correct identified deficiencies or to enhance overall environmental performance and compliance on the Project;

- Taking all necessary precautions or actions in relation to any activity conducted on the Project that may potentially cause environmental harm and ensuring compliance with this Project CEMP and relevant regulations including the development and implementation of an environmental monitoring program;

- Providing initial and ongoing environmental awareness training including induction training for all new employees detailing each person's individual environmental responsibilities and key aspects of the Project CEMP and their own environmental objectives and compliance plans, and any other details specific to their individual work scope on the Project;

- The immediate reporting to the project manager of all environmental incidents, non-conformances, or concerns and the timely implementation of corrective actions or remediation strategies to control or ameliorate the extent of environmental harm; and

- Ensure that all environmental complaints are handled in a prompt and courteous manner and in compliance with the guidelines contained in this CEMP.

## WORKS IN THE PUBLIC DOMAIN

Works associated with the development will take place outside of the main site footprint such as road works and provision of site services.

The Principal Contractor will consider the following indicative issues with regards to local authority assets:

- Local authority assets such as roads, kerbing and channels etc, stormwater drains and street furniture will be protected and made good if damaged as a direct result of the building work;

- Priority repair will be given to those areas relied upon by pedestrians, cyclists and motorists' safety; and

- Any services installation such as electrical, drainage etc. that extends over footpaths will be temporarily covered over and pedestrian and

disability access facilitated by a ramp until such time as full reinstatement is complete.

## SAFETY AND SECURITY

The following indicative issues will be considered with regards to the safety and security of the site:

- Adequate lighting, safety signage and traffic controls will be provided in accordance with Codes of Practice (from RTA, Sydney City Council etc.);

- Traffic controls and a traffic management plan will be developed and will comply with the relevant legislation;

- Any temporary or permanent changes to street lighting will be approved by the relevant authority;

- Security measures will be in place at all times when the site is not in operation;

- If the site cannot be fully secured, then consideration may be given to a security service, with patrols or fixed guards; and

- Hazardous chemicals will be stored in accordance with the relevant Australian Standard (mainly including items such as fuel, paints, and solvents).

## FIRE PRECAUTIONS DURING CONSTRUCTION

During construction there is to be:

- not less than one fire extinguisher to suit Class A, B and C fires and electrical fires must be provided at all times on each storey adjacent to each required exit or temporary stairway or exit, in accordance with NCC Volume 1 Part E1.9(a)

## EMERGENCY PROCEDURES

Emergency services will be informed of the location and nature of the works and the nature of potentially hazardous materials encountered at the Site during the demolition and recycling works and the early works in general. Emergency procedures on site will cover actions to be taken if a serious event occurs. Serious events may include but not be limited to:

- Oil or other contamination spillage;
- Collapse or potential collapse of a structure;
- Fire and explosion;
- Failure of any control structures;

- Industrial accident.

In order to ensure that the environmental impact of catastrophic events is minimised, emergency procedures are to be followed. These include:

- The first priority is the safety of any persons either workers or others involved in the events;

- Whatever reasonable actions necessary to protect safety will be taken. The site Occupational Health and Safety Plan will outline actions to be taken in relation to safety of persons if these circumstances eventuate;

- The second priority is to quickly minimise the environmental damage. All emergency action should take place as soon as possible after the event.

Actions to be taken may include:

- The containment of any pollution by booms, silt fences or other means. Supplies of silt fences are to be kept on-site;

- The temporary re-establishment of the control structure; and

- The taking of appropriate samples to assess the extent of the problem.

## DUST SUPPRESSION

- Water sprays will be used for dust suppression across unsealed areas of the site, stockpiles and other dust generating areas. The water will be applied to the area at a rate sufficient to maintain dust control.

## WORKPLACE HEALTH & SAFETY

THESE NOTES MUST BE READ AND UNDERSTOOD BY ALL INVOLVED IN THE PROJECT. THIS INCLUDES (but is not exclusive to): OWNER, BUILDER, SUB-CONTRACTORS, CONSULTANTS, RENOVATORS, OPERATORS, MAINTENORS, and DEMOLISHERS.

### 1. FALLS, SLIPS, TRIPS

#### A) WORKING AT HEIGHTS

#### DURING CONSTRUCTION

Wherever possible, components for this building should be prefabricated off-site or at ground level to minimise the risk of workers falling more than two metres. However, construction of this building will

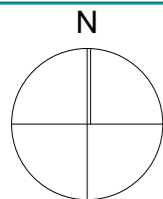

## HOWARD LESLIE & ASSOCIATES

residential and commercial building design

p | 02 4323 4505  
e | david@hlabuildingdesign.com.au  
a | PO Box 3206, ERINA NSW 2250  
© Reproduction in part or full is prohibited by Copyright



## Community Project

for:  
**HMAS Adelaide Monument**  
at:  
**The Haven. Scenic Hwy TERRIGAL NSW 2260**  
lot: 6 dp: 857477

REV	Issue	Date
01	Issue DA	5/03/2019
02	Re-Issue DA	31/08/2020
03	Re-Issue DA	14/09/2020
04	Re-Issue DA	6/11/2020

## GENERAL NOTES 1

BASIX Cert: #BASIX Cert #  
BAL Rating: #BAL Rating  
drawn: DR  
checked: DR  
print date: 6/11/2020

Issue:

04

sheet #:

16595-  
A3-02

scale @ A3:

require workers to be working at heights where a fall in excess of two metres is possible and injury is likely to result from such a fall. The builder should provide a suitable barrier wherever a person is required to work in a situation where falling more than two metres is a possibility.

**DURING OPERATION OR MAINTENANCE**

For houses or other low-rise buildings where scaffolding is appropriate:

Cleaning and maintenance of windows, walls, roof or other components of this building will require persons to be situated where a fall from a height in excess of two metres is possible. Where this type of activity is required, scaffolding, ladders or trestles should be used in accordance with relevant codes of practice, regulations or legislation.

For buildings where scaffold, ladders, trestles are not appropriate:

Cleaning and maintenance of windows, walls, roof or other components of this building will require persons to be situated where a fall from a height in excess of two metres is possible. Where this type of activity is required, scaffolding, fall barriers or Personal Protective Equipment (PPE) should be used in accordance with relevant codes of practice, regulations or legislation.

**ANCHORAGE POINTS**

Anchorage points for portable scaffold or fall arrest devices have been included in the design for use by maintenance workers. Any persons engaged to work on the building after completion of construction work should be informed about the anchorage points.

**B) SLIPPERY OR UNEVEN SURFACES**

**FLOOR FINISHES Specified**

If finishes have been specified by designer, these have been selected to minimise the risk of floors and paved areas becoming slippery when wet or when walked on with wet shoes/feet. Any changes to the specified finish should be made in consultation with the designer or, if this is not practical, surfaces with an equivalent or better slip resistance should be chosen.

**CONSTRUCTION NOISE MANAGEMENT AND MITIGATION**

Control of noise arising from the works in accordance with the requirements of the Protection of the Environment Operations Act 1997 and guidelines contained in the New South Wales Environment Protection Authority Environmental Noise Control Manual.

Principal contractor to make provisions for the prevention of any paint spillages or other damage to the public footpath while work is being carried out.

Hours for building noise and work hours required by Council:

Monday to Friday - 7:00am to 6:00pm

Saturday - 8:00am to 5:00pm

Work is not to be carried out on Sundays or Public Holidays

Australian Standard AS 2436-2010 'Guide to Noise Control on Construction, Maintenance and Demolition Sites' sets out numerous practical recommendations to assist in mitigating construction noise emissions. Recommendations provided in this standard include operational strategies, source noise control strategies, noise barrier controls, and community consultation.

It is estimated that adopting strategies contained in this standard may result in the following noise attenuation:

- up to 10 dB(A) where space requirements place limitations on the attenuation options available;

and

- up to 20 dB(A) in situations where noise source noise mitigation measures

(silencers, mufflers, etc.) can be combined with noise barriers and other management techniques.

Further descriptions of management measures and mitigation options are provided for specific construction activities and work areas in the following sections. General noise mitigation and management measures are included in Table 4.1.

**STANDARD CONSTRUCTION ACTIVITIES**

During construction activities, the following noise management and mitigation strategies should be adopted where feasible:

- plant, where possible, to be strategically positioned to provide shielding where noise generation at a site is predicted to be above criteria at surrounding receptors;
- limitation of use of acoustically significant plant (reticulation pumps) to minimise exposure to nearby residences (where possible);
- undertake regular maintenance of machinery to minimise noise emissions. Maintenance will be confined to standard daytime construction hours and where possible, away from noise sensitive receivers; and
- hydraulic fracture stimulation to use localised screens to block line of site from construction plant to adjacent receivers, screens may include other not operational plant, shipping containers, site sheds etc.

**TRUCKING OPERATIONS**

Mitigation strategies to manage noise from on-site truck operations include:

- trucks will be well maintained; and
- trucks will adhere to the designated speed limits in and around local streets.

**DANGEROUS GOODS MANAGEMENT**

It is not envisaged that any dangerous goods will be required as part of the demolition and remediation works. If the need arises, then the following points below will be adhered to:

- Sub-contractors to provide list of hazardous chemicals and MSDS to the Principal Contractor prior to bringing chemicals on site;

- No chemicals to come onto site unaccompanied by a suitable MSDS;

- MSDS, chemical inventory and copy of Emergency Response Plan be held at each storage facility;

- Designated hazardous substances or dangerous goods require Principal Contractor Project Manager approval prior to bringing on Site;

- Corrosive materials to be stored and handled in accordance with AS3780.8 (Class 8 substances – Corrosives);

- All fuel, oils and chemicals must be clearly labelled;

- Transfer of bulk fuel and handling of hazardous chemicals to be conducted only by appropriately trained personnel;

- Spill clean-up kits including absorbent materials will be kept at each storage place.

- No permanent bulk oil storage areas would be permitted;

- All temporary fuel, oil, or chemical storage areas shall be bunded, have suitable fire protection, appropriate procedures for monitoring and clearing accumulated stormwater, and appropriate procedures for spill containment and clean up with equipment stored in close proximity ready for immediate use;

- Operational procedures for bulk oil or chemical handling, delivery and disposal shall be documented and shall be in accordance with the relevant regulations and Australian Standards;

- Only personnel trained in the relevant procedures and in contingency action and spill clean-up procedures shall supervise the loading and unloading of bulk oil and chemicals (if any); and

- Appropriate quantities of spill containment material shall be available for immediate use

**CONTRACTORS AND SUBCONTRACTORS**

All contractors and subcontractors have environmental responsibilities during the performance of their various activities on the Project in particular:

- The submission to the Project Manager of their own documentation which complies with Federal, State, and Local Authority regulations and the contents of this CEMP,

- The preparation and implementation of specific environmental control plans deemed necessary by the Project Manager or his nominee to correct identified deficiencies or to enhance overall environmental performance and compliance on the Project;

- Taking all necessary precautions or actions in relation to any activity conducted on the Project that may potentially cause environmental harm and ensuring compliance with this Project CEMP and relevant regulations including the development and implementation of an environmental monitoring program;

- Providing initial and ongoing environmental awareness training including induction training for all new employees detailing each person's individual environmental responsibilities and key aspects of the Project CEMP and their own environmental objectives and compliance plans, and any other details specific to their individual work scope on the Project;

- The immediate reporting to the project manager of all environmental incidents, non-conformances, or concerns and the timely implementation of corrective actions or remediation strategies to control or ameliorate the extent of environmental harm; and

- Ensure that all environmental complaints are handled in a prompt and courteous manner and in compliance with the guidelines contained in this CEMP.

**WORKS IN THE PUBLIC DOMAIN**

Works associated with the development will take place outside of the main site footprint such as road works and provision of site services.

The Principal Contractor will consider the following indicative issues with regards to local authority assets:

- Local authority assets such as roads, kerbing and channels etc, stormwater drains and street furniture will be protected and made good if damaged as a direct result of the building work;

- Priority repair will be given to those areas relied upon by pedestrians, cyclists and motorists' safety; and

- Any services installation such as electrical, drainage etc. that extends over footpaths will be temporarily covered over and pedestrian and

E:\Projects\16595\_HMAS Adelaide\16595\_HMAS Adelaide.dwg, James16595\_HMAS Adelaide, 12/02/2020 12:02 PM

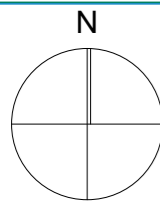

**HOWARD LESLIE & ASSOCIATES**

residential and commercial building design

p | 02 4323 4505  
 e | david@hlabuildingdesign.com.au  
 a | PO Box 3206, ERINA NSW 2250  
 © Reproduction in part or full is prohibited by Copyright



**Community Project**

for: **HMAS Adelaide Monument**  
 at: **The Haven. Scenic Hwy TERRIGAL NSW 2260**  
 lot: 6 dp: 857477

REV	Issue	Date
01	Issue DA	5/03/2019
02	Re-Issue DA	31/08/2020
03	Re-Issue DA	14/09/2020
04	Re-Issue DA	6/11/2020

**GENERAL NOTES 2**

BASIX Cert: #BASIX Cert #	Issue:	sheet #:
BAL Rating: #BAL Rating	<b>04</b>	<b>16595-A3-03</b>
drawn: DR		
checked: DR		
print date: 6/11/2020		
scale @ A3:		

disability access facilitated by a ramp until such time as full reinstatement is complete.

### SAFETY AND SECURITY

The following indicative issues will be considered with regards to the safety and security of the site:

- Adequate lighting, safety signage and traffic controls will be provided in accordance with Codes of Practice (from RTA, Sydney City Council etc.);
- Traffic controls and a traffic management plan will be developed and will comply with the relevant legislation;
- Any temporary or permanent changes to street lighting will be approved by the relevant authority;
- Security measures will be in place at all times when the site is not in operation;
- If the site cannot be fully secured, then consideration may be given to a security service, with patrols or fixed guards; and
- Hazardous chemicals will be stored in accordance with the relevant Australian Standard (mainly including items such as fuel, paints, and solvents).

### FIRE PRECAUTIONS DURING CONSTRUCTION

During construction there is to be:

- not less than one fire extinguisher to suit Class A, B and C fires and electrical fires must be provided at all times on each storey adjacent to each required exit or temporary stairway or exit, in accordance with NCC Volume 1 Part E1.9(a)

### EMERGENCY PROCEDURES

Emergency services will be informed of the location and nature of the works and the nature of potentially hazardous materials encountered at the Site during the demolition and recycling works and the early works in general. Emergency procedures on site will cover actions to be taken if a serious event occurs. Serious events may include but not be limited to:

- Oil or other contamination spillage;
- Collapse or potential collapse of a structure;
- Fire and explosion;
- Failure of any control structures;

- Industrial accident.

In order to ensure that the environmental impact of catastrophic events is minimised, emergency procedures are to be followed. These include:

- The first priority is the safety of any persons either workers or others involved in the events;
- Whatever reasonable actions necessary to protect safety will be taken. The site Occupational Health and Safety Plan will outline actions to be taken in relation to safety of persons if these circumstances eventuate;
- The second priority is to quickly minimise the environmental damage. All emergency action should take place as soon as possible after the event.

Actions to be taken may include:

- The containment of any pollution by booms, silt fences or other means. Supplies of silt fences are to be kept on-site;
- The temporary re-establishment of the control structure; and
- The taking of appropriate samples to assess the extent of the problem.

### DUST SUPPRESSION

- Water sprays will be used for dust suppression across unsealed areas of the site, stockpiles and other dust generating areas. The water will be applied to the area at a rate sufficient to maintain dust control.

### WORKPLACE HEALTH & SAFETY

THESE NOTES MUST BE READ AND UNDERSTOOD BY ALL INVOLVED IN THE PROJECT. THIS INCLUDES (but is not exclusive to): OWNER, BUILDER, SUB-CONTRACTORS, CONSULTANTS, RENOVATORS, OPERATORS, MAINTENORS, and DEMOLISHERS.

### 1. FALLS, SLIPS, TRIPS

#### A) WORKING AT HEIGHTS

#### DURING CONSTRUCTION

Wherever possible, components for this building should be prefabricated off-site or at ground level to minimise the risk of workers falling more than two metres. However, construction of this building will

require workers to be working at heights where a fall in excess of two metres is possible and injury is likely to result from such a fall. The builder should provide a suitable barrier wherever a person is required to work in a situation where falling more than two metres is a possibility.

#### DURING OPERATION OR MAINTENANCE

For houses or other low-rise buildings where scaffolding is appropriate:

Cleaning and maintenance of windows, walls, roof or other components of this building will require persons to be situated where a fall from a height in excess of two metres is possible. Where this type of activity is required, scaffolding, ladders or trestles should be used in accordance with relevant codes of practice, regulations or legislation.

For buildings where scaffold, ladders, trestles are not appropriate:

Cleaning and maintenance of windows, walls, roof or other components of this building will require persons to be situated where a fall from a height in excess of two metres is possible. Where this type of activity is required, scaffolding, fall barriers or Personal Protective Equipment (PPE) should be used in accordance with relevant codes of practice, regulations or legislation.

#### ANCHORAGE POINTS

Anchorage points for portable scaffold or fall arrest devices have been included in the design for use by maintenance workers. Any persons engaged to work on the building after completion of construction work should be informed about the anchorage points.

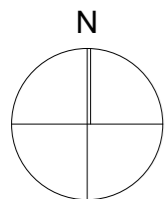

## HOWARD LESLIE & ASSOCIATES

residential and commercial building design

p | 02 4323 4505  
e | david@hlabuildingdesign.com.au  
a | PO Box 3206, ERINA NSW 2250  
© Reproduction in part or full is prohibited by Copyright



## Community Project

for: **HMAS Adelaide Monument**  
at: **The Haven. Scenic Hwy TERRIGAL NSW 2260**  
lot: 6 dp: 857477

REV	Issue	Date
01	Issue DA	5/03/2019 1
02	Re-Issue DA	31/08/2020
03	Re-Issue DA	14/09/2020
04	Re-Issue DA	6/11/2020 1

## GENERAL NOTES 3

BASIX Cert: #BASIX Cert #  
BAL Rating: #BAL Rating  
drawn: DR  
checked: DR  
print date: 6/11/2020  
scale @ A3:

Issue:  
**04**

sheet #:  
**16595-  
A3-04**

# Landscape Management - Trees

## Existing Vegetation to be Retained and Protected:

- \* All existing trees shown to be retained are to be protected in Accordance with "the act landscape guidelines" & The "basic specification for road, hydraulic Services and landscape vol. 1, edition no.1 July 1991" - unless noted otherwise. Refer to ACT Environment Tree Damaging Activity Approval.
- \* No storage of materials/waste or parking is permitted within the tree protection zone (2m outside the drip zone) of significant trees
- \* Existing crown and apex not to be altered unless noted otherwise.
- \* Ensure construction equipment can pass beneath lowest limb without damage to trees.
- \* Access requiring excavation is not permitted on two sides of trees.
- \* All work within the drip zone must be undertaken by hand.
- \* Do not sever large roots (greater than 30mm dia) closer than halfway from the drip line to the trunk.
- \* All roots must be cut cleanly with equipment specially designed to cut roots.
- \* Roots exposed during excavation must be protected from drying out.

## Waste Management:

- \* No unauthorised use of public land for storage of waste/recyclables or parking is permitted. The method of disposal for all demolished structures and vegetation shall be as per the Waste Management Plan Parts 1,2 & 3

## Temporary Fencing:

- \* Temporary 1800H chain wire verge protection fence to be erected prior to commencement of the works.
- \* Temporary protection fences may be required around significant trees on site also, in accordance with ACT Environment recommendations. Refer to ACT Environment Tree Damaging Activity Approval.
- \* Remove fencing for landscape restoration only after the completion of construction works

## Temporary Access:

- \* Temporary access across verge: where possible use existing driveways.

## Reinstatement:

- \* The contractor is responsible for the reinstatement of all damages incurred to land, vegetation, services, paths, roads and other public property, as a result of this construction work.
- \* At the completion of construction, verges are to be restored to non irrigated grass. Top soil is not to be removed and the soil level must not be changed

## Work On Site Only:

- \* All construction work is to be contained within the site except for work otherwise approved by all relevant authorities.
- \* Advertising, signage, and the like to be located within the property boundary



Site location



Site location

GFA:

Site Coverage

Reposition sign

Approximate site location

Proposed Ship Mast

Proposed Monument Plaque

Provide smooth transition between existing and proposed concrete surfaces

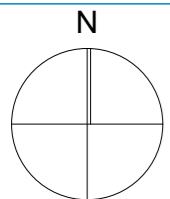
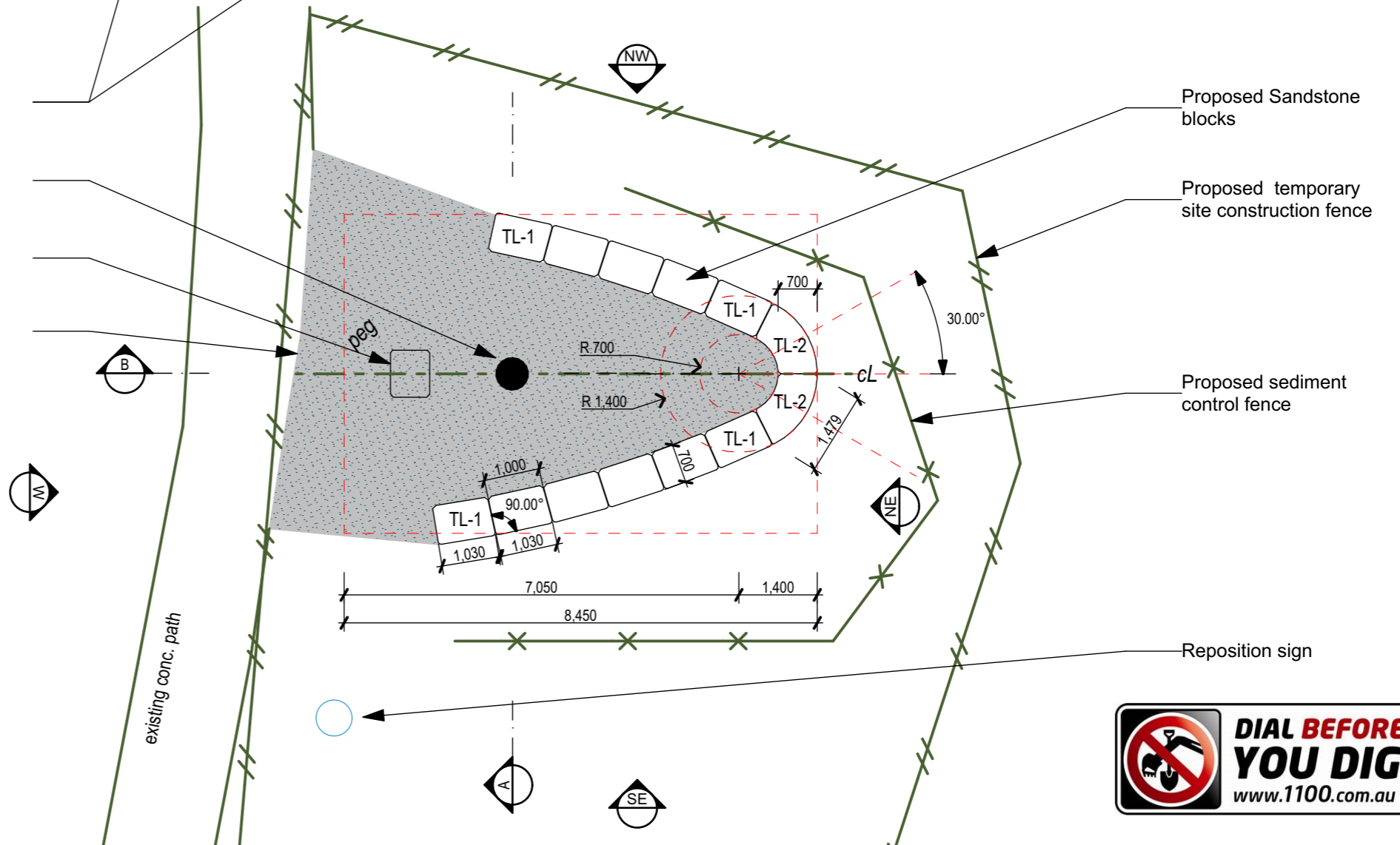
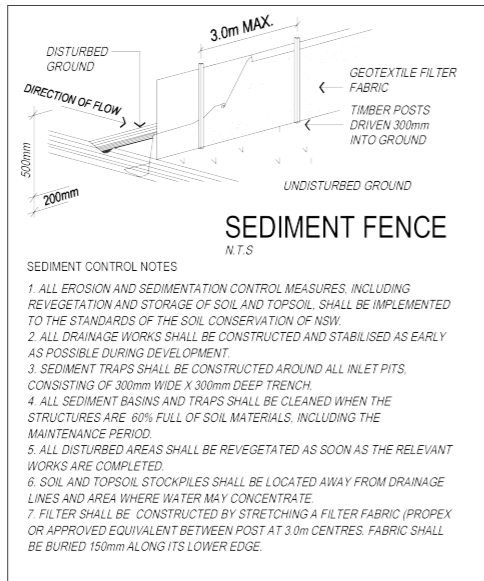

## HOWARD LESLIE & ASSOCIATES

residential and commercial building design

p | 02 4323 4505  
e | david@hlabuildingdesign.com.au  
a | PO Box 3206, ERINA NSW 2250



ACCREDITED MEMBER OF BUILDING DESIGNERS AUSTRALIA

## Community Project

for: **HMAS Adelaide Monument**  
at: **The Haven. Scenic Hwy TERRIGAL NSW 2260**  
lot: 6 dp: 857477

REV	Issue	Date
01	Issue DA	5/03/2019
02	Re-Issue DA	31/08/2020
03	Re-Issue DA	14/09/2020
04	Re-Issue DA	6/11/2020

## SITE PLAN

BASIX Cert: #BASIX Cert #	Issue:	sheet #:
BAL Rating: #BAL Rating	04	16595-
drawn: DR		A3-10
checked: DR		
print date: 6/11/2020		
scale @ A3: 1:1.33, 1:100, 1:200		

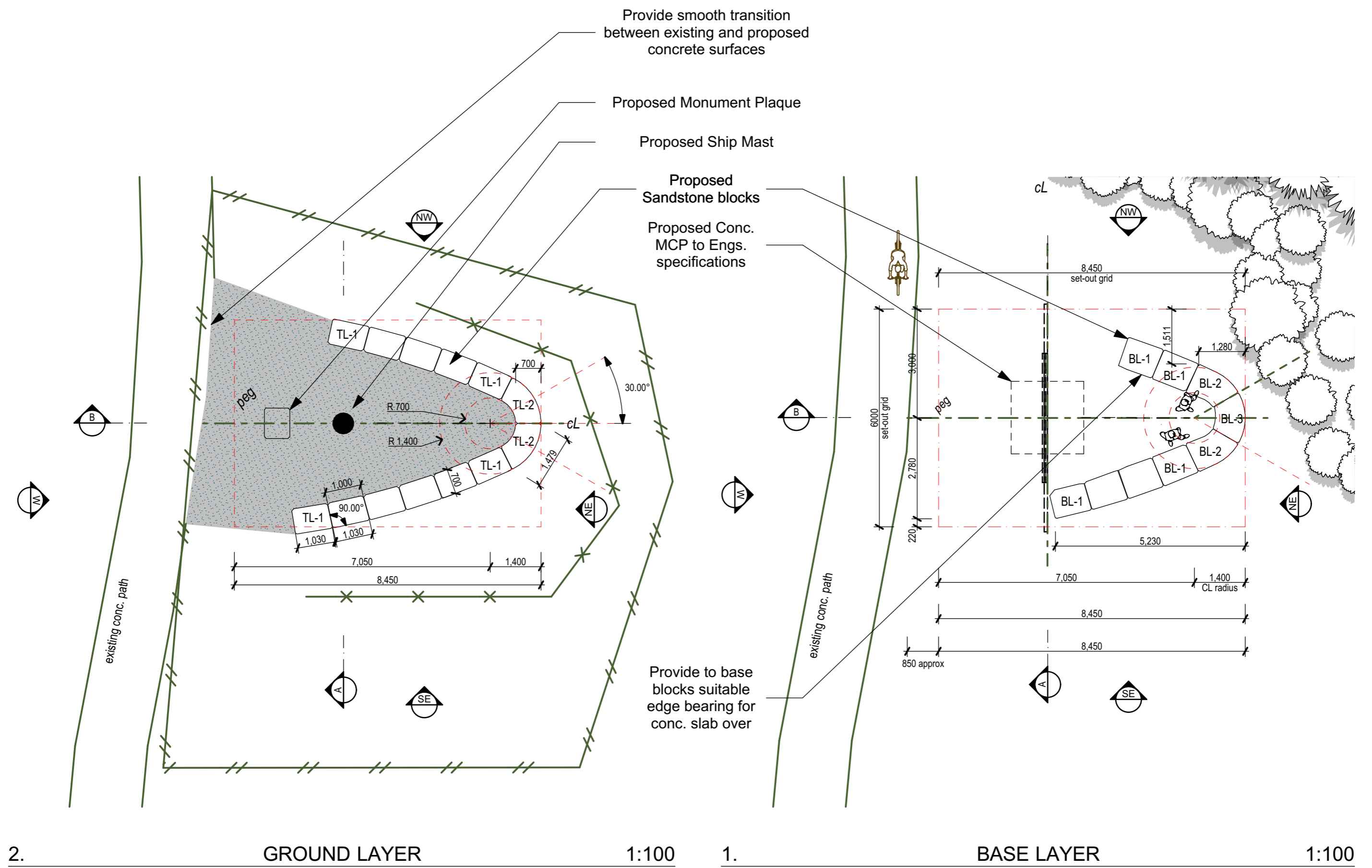

2. GROUND LAYER 1:100

1. BASE LAYER 1:100

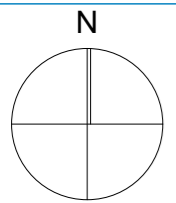

# HOWARD LESLIE & ASSOCIATES

residential and commercial building design

p | 02 4323 4505  
 e | david@hlabuildingdesign.com.au  
 a | PO Box 3206, ERINA NSW 2250



## Community Project

for: **HMAS Adelaide Monument**  
 at: **The Haven. Scenic Hwy TERRIGAL NSW 2260**  
 lot: 6 dp: 857477

REV	Issue	Date
01	Issue DA	5/03/2019
02	Re-Issue DA	31/08/2020
03	Re-Issue DA	14/09/2020
04	Re-Issue DA	6/11/2020

## BASE and GROUND

BASIX Cert: #BASIX Cert #  
 BAL Rating: #BAL Rating  
 drawn: DR  
 checked: DR  
 print date: 6/11/2020  
 scale @ A3: 1 : 50

Issue: **04**

sheet #: **16595-A3-23**

F:\projects\16595\_HMAS Adelaide\16595\_HMAS Adelaide.dwg  
 Last saved: 14/09/2020 12:02 PM

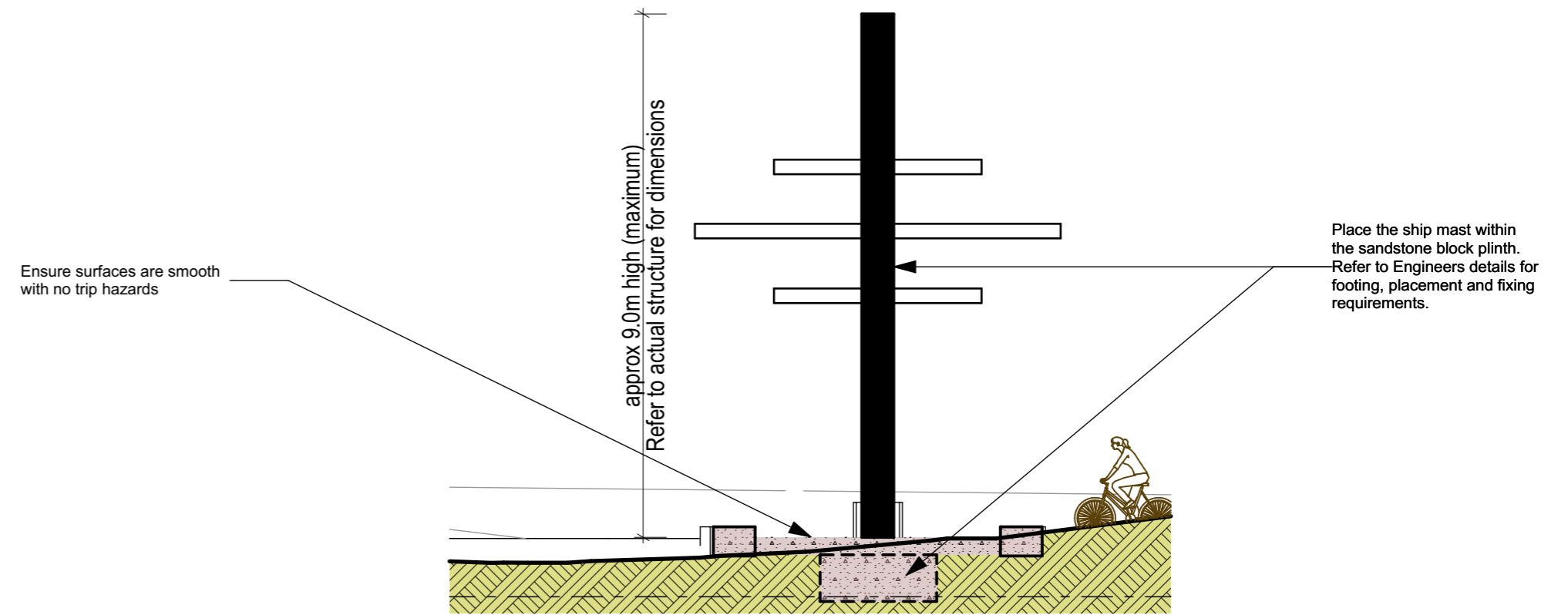

GROUND 50.005.000

**A**  
A3-23 SECTION 1:100

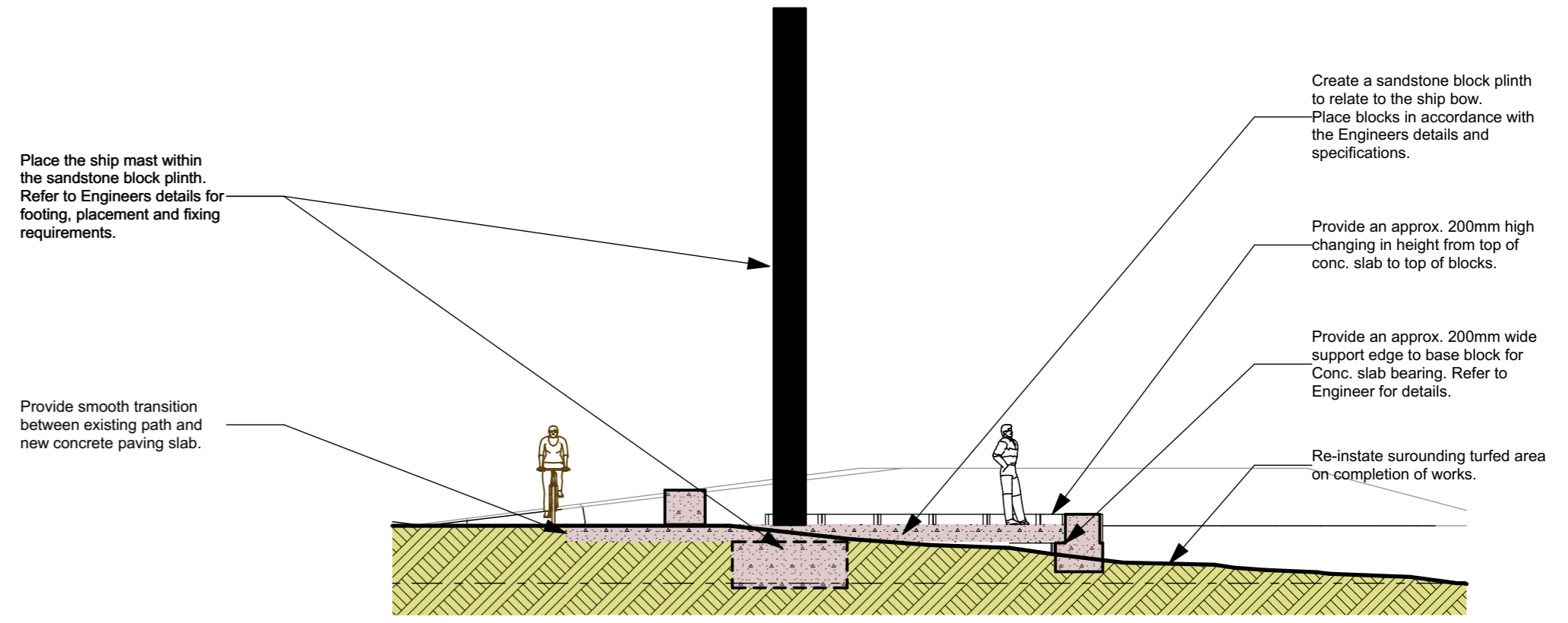

**B**  
A3-23 SECTION 1:100

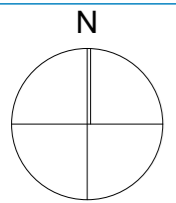

**HOWARD LESLIE & ASSOCIATES**  
residential and commercial building design

p | 02 4323 4505  
e | david@hlabuildingdesign.com.au  
a | PO Box 3206, ERINA NSW 2250  
© Reproduction in part or full is prohibited by Copyright



**Community Project**  
for: **HMAS Adelaide Monument**  
at: **The Haven. Scenic Hwy TERRIGAL NSW 2260**  
lot: 6 dp: 857477

REV	Issue	Date
01	Issue DA	5/03/2019
02	Re-Issue DA	31/08/2020
03	Re-Issue DA	14/09/2020
04	Re-Issue DA	6/11/2020

SECTIONS	
BASIX Cert: #BASIX Cert #	
BAL Rating: #BAL Rating	
drawn: DR	
checked: DR	
print date: 6/11/2020	
scale @ A3: 1:100	

Issue:	sheet #:
<b>04</b>	<b>16595-A3-30</b>

F:\projects\16595\_HMAS Adelaide\16595\_HMAS Adelaide.dwg James 16/09/2020 12:02 PM  
 Last saved: 14/09/2020 12:02 PM



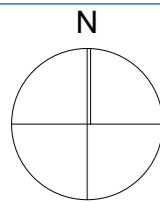
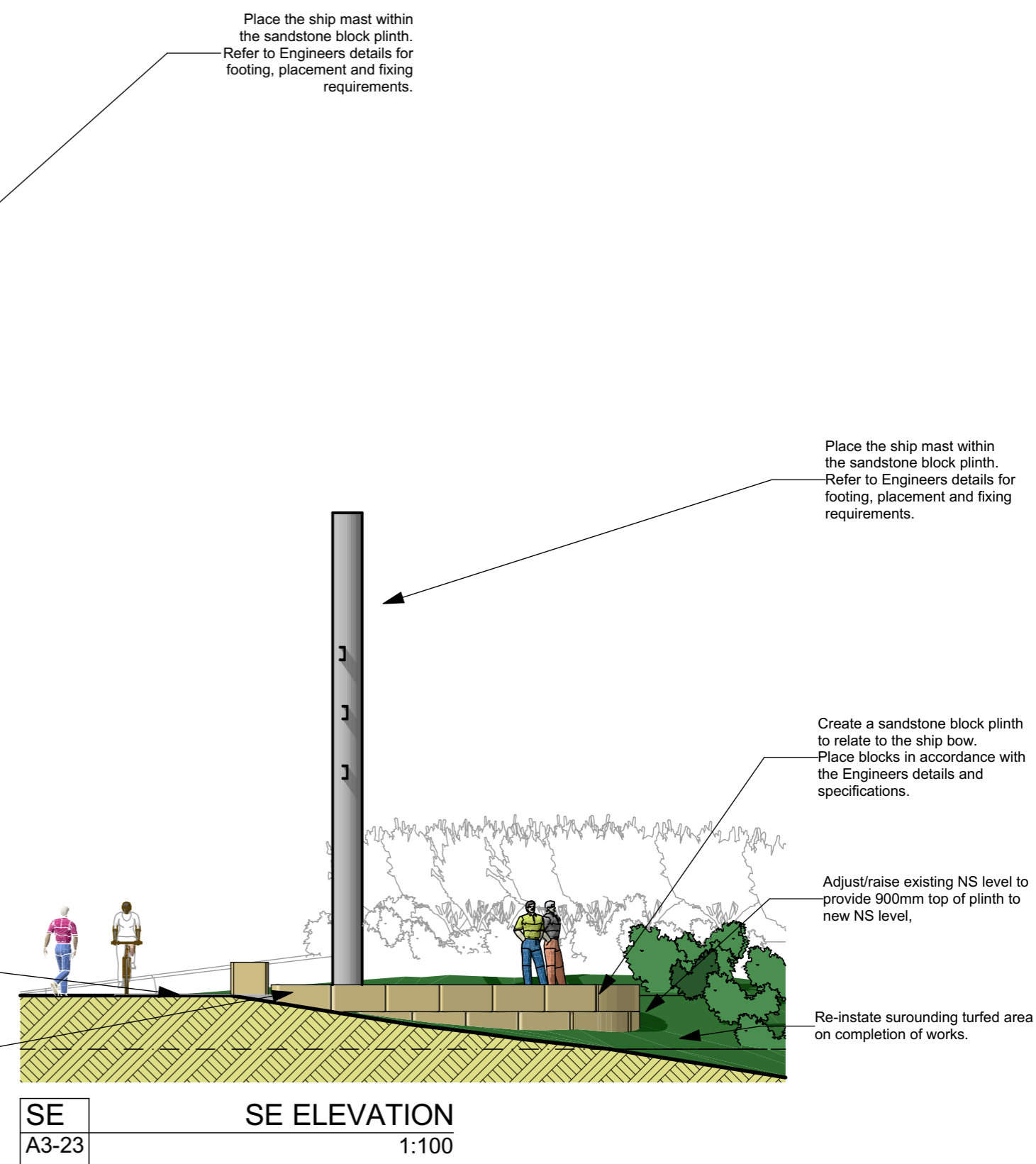
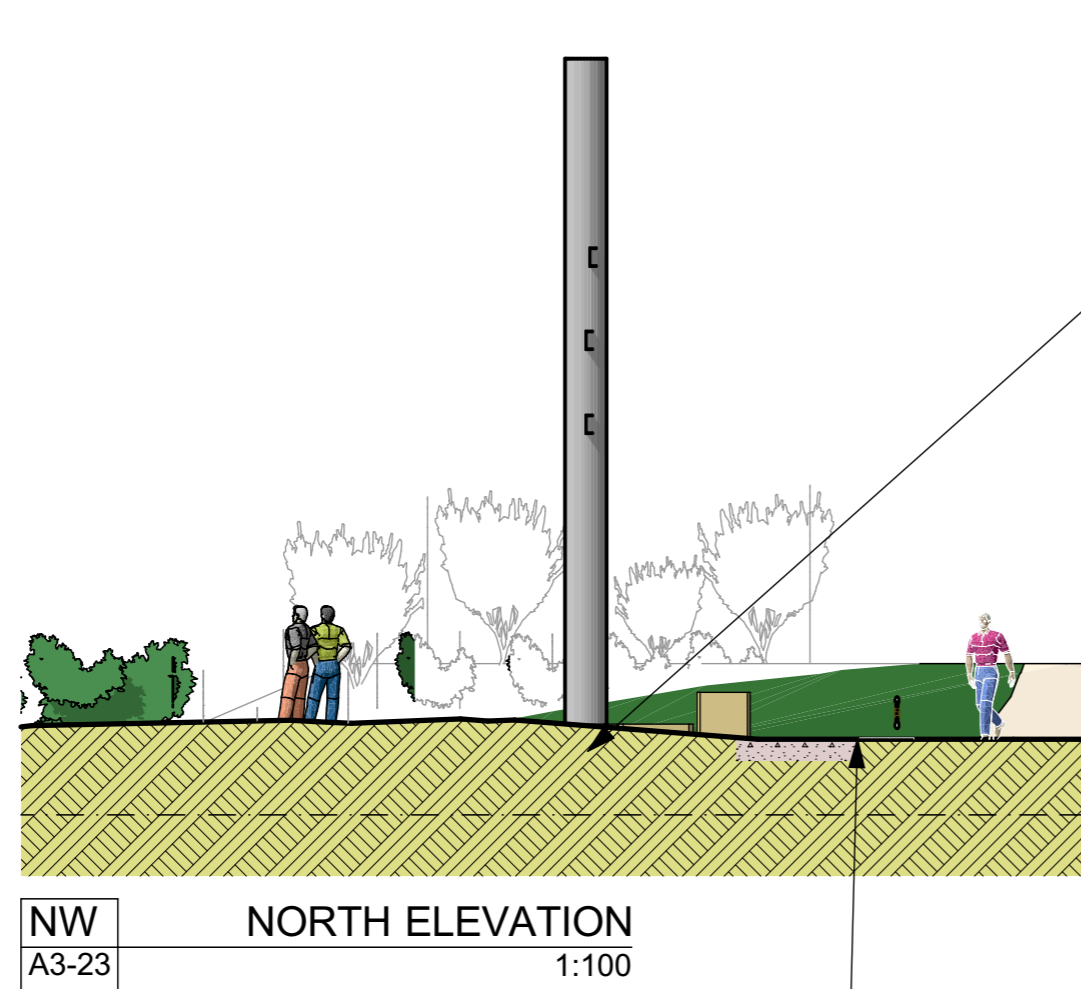

**HOWARD LESLIE & ASSOCIATES**

residential and commercial building design

p | 02 4323 4505  
e | david@hlabuildingdesign.com.au  
a | PO Box 3206, ERINA NSW 2250  
© Reproduction in part or full is prohibited by Copyright



**Community Project**

for:  
**HMAS Adelaide Monument**  
at:  
**The Haven. Scenic Hwy TERRIGAL NSW 2260**  
lot: 6 dp: 857477

REV	Issue	Date
01	Issue DA	5/03/2019
02	Re-Issue DA	31/08/2020
03	Re-Issue DA	14/09/2020
04	Re-Issue DA	6/11/2020

**NW & SE ELEVATIONS**

BASIX Cert: #BASIX Cert #
BAL Rating: #BAL Rating
drawn: DR
checked: DR
print date: 6/11/2020
scale @ A3: 1:100

Issue:	sheet #:
<b>04</b>	<b>16595-A3-40</b>

F:\projects\16595\_HMAS Adelaide\16595\_HMAS Adelaide.dwg  
 User: david@hlabuildingdesign.com.au  
 Last saved: 14/09/2020 12:02 PM

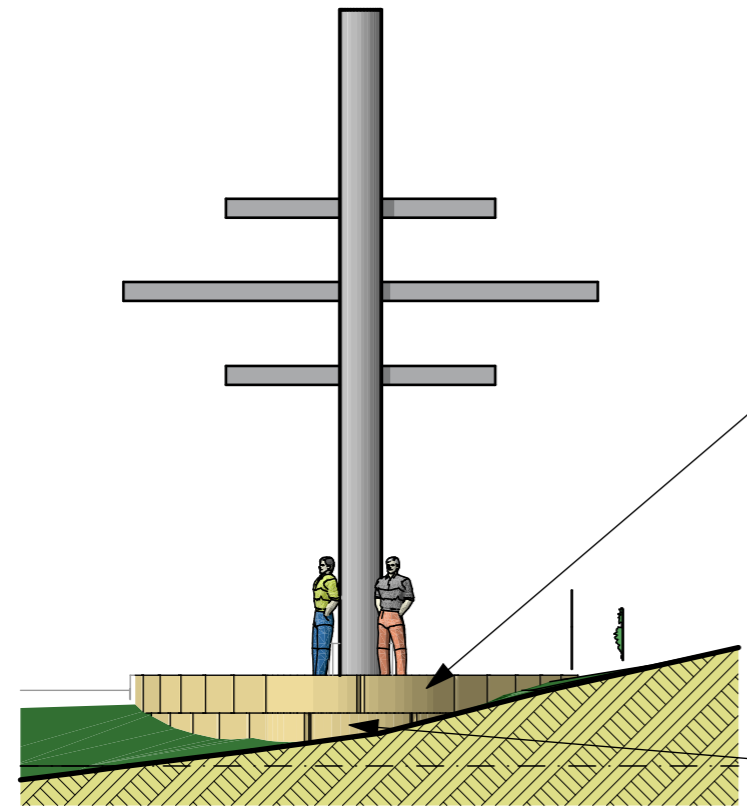

**NE**  
A3-23  
**NE ELEVATION**  
1:100

Create a sandstone block plinth to relate to the ship bow. Place blocks in accordance with the Engineers details and specifications.

Adjust/raise existing NS level to provide 900mm top of plinth to new NS level,

Place the ship mast within the sandstone block plinth. Refer to Engineers details for footing, placement and fixing requirements.

Ensure surfaces are smooth with no trip hazards

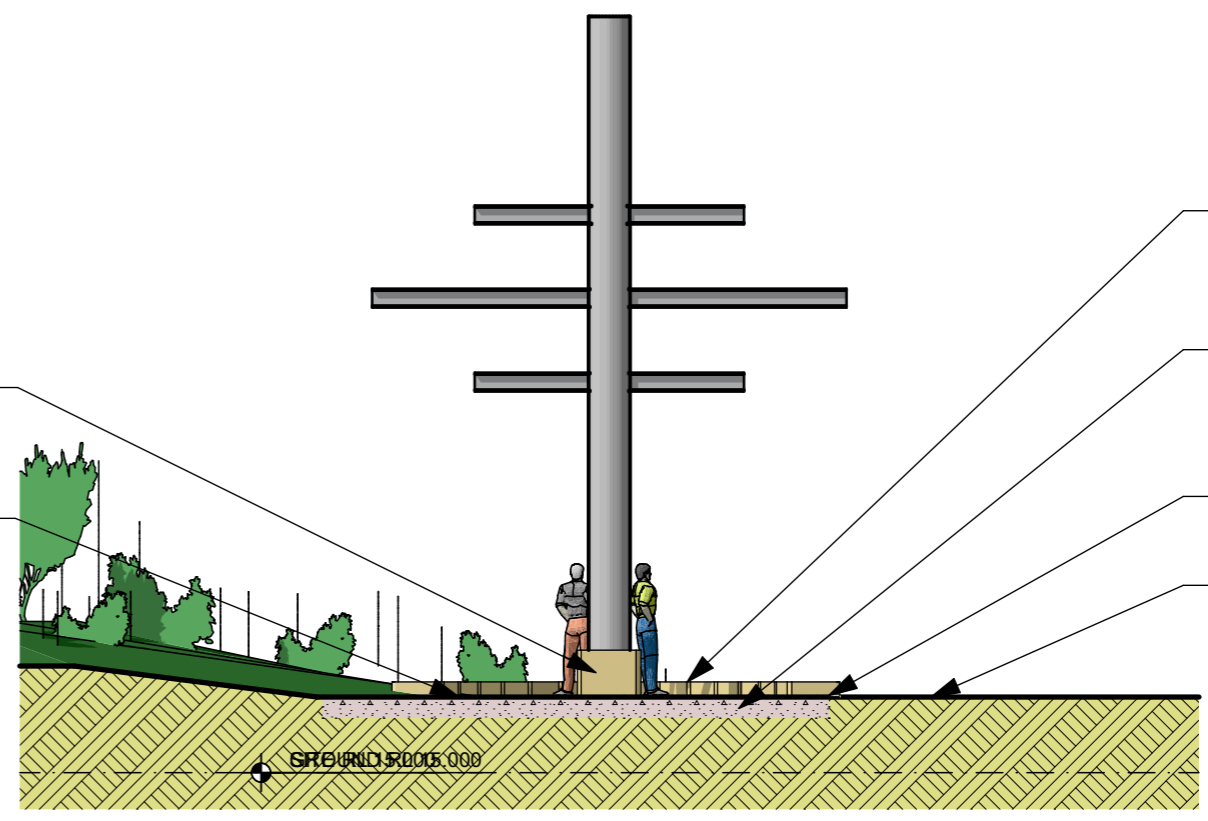

**SW**  
A3-23  
**WEST ELEVATION**  
1:100

Provide an approx. 200mm high changing in height from top of conc. slab to top of blocks.

Provide an approx. 200mm wide support edge to base block for Conc. slab bearing. Refer to Engineer for details.

Provide smooth transition between existing path and new concrete paving slab.

Re-instate surrounding turfed area on completion of works.

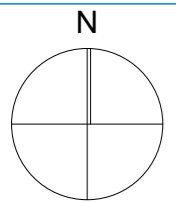

**HOWARD LESLIE & ASSOCIATES**

residential and commercial building design

p | 02 4323 4505  
e | david@hlabuildingdesign.com.au  
a | PO Box 3206, ERINA NSW 2250  
© Reproduction in part or full is prohibited by Copyright



**Community Project**

for: **HMAS Adelaide Monument**  
at: **The Haven. Scenic Hwy TERRIGAL NSW 2260**  
**lot: 6 dp: 857477**

REV	Issue	Date
01	Issue DA	5/03/2019
02	Re-Issue DA	31/08/2020
03	Re-Issue DA	14/09/2020
04	Re-Issue DA	6/11/2020

**NE & SW ELEVATION**

BASIX Cert: #BASIX Cert #
BAL Rating: #BAL Rating
drawn: DR
checked: DR
print date: 6/11/2020
scale @ A3: 1:100

Issue:  
**04**

sheet #:  
**16595-A3-41**

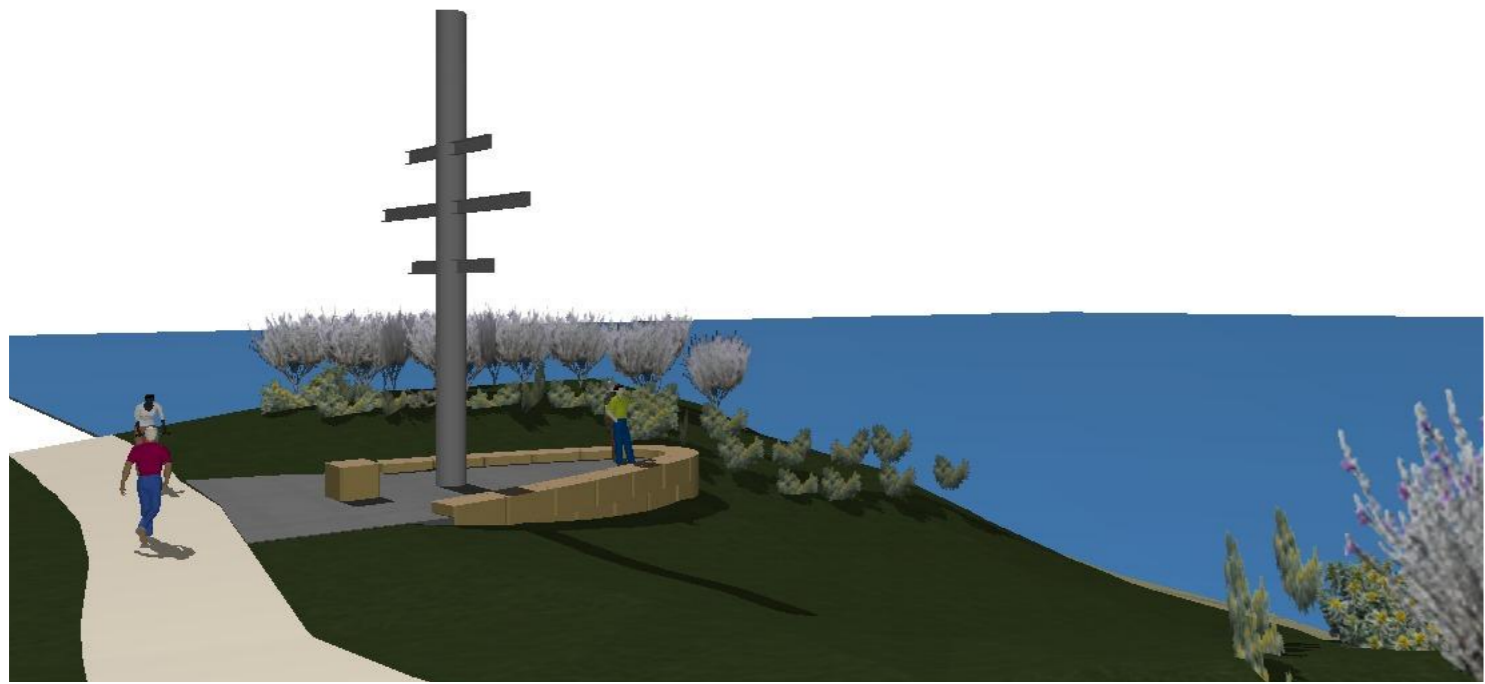

Impression 2 1:200



Site Location 1:5.56



Impression 1 1:200

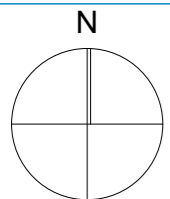

# HOWARD LESLIE & ASSOCIATES

residential and commercial building design

p | 02 4323 4505  
 e | david@hlabuildingdesign.com.au  
 a | PO Box 3206, ERINA NSW 2250  
 © Reproduction in part or full is prohibited by Copyright



## Community Project

for:  
**HMAS Adelaide Monument**  
 at:  
**The Haven. Scenic Hwy TERRIGAL NSW 2260**  
 lot: 6 dp: 857477

REV	Issue	Date
01	Issue DA	5/03/2019
02	Re-Issue DA	31/08/2020
03	Re-Issue DA	14/09/2020
04	Re-Issue DA	6/11/2020

## EXTERNAL VIEWS

BASIX Cert: #BASIX Cert #
BAL Rating: #BAL Rating
drawn: DR
checked: DR
print date: 6/11/2020
scale @ A3:

Issue:  
**04**

sheet #:  
**16595-A3-90**

F:\projects\16595\_HMAS Adelaide\16595\_HMAS Adelaide\_james16595\_HMAS Adelaide\_V22.rvt  
 Last saved: 14/09/2020 12:02 PM